

The buttons on the digital clock can be used for general clock configuration and advanced debug.

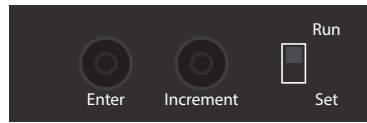

Go to the top of the clock case to change settings on the digital clock. Begin by switching to Set and using the Enter and Increment buttons as required, referencing the Figures below. When complete, switch back to the Run position.

Fig. 1

Set the clock into provisioning mode in which the settings can be changed.

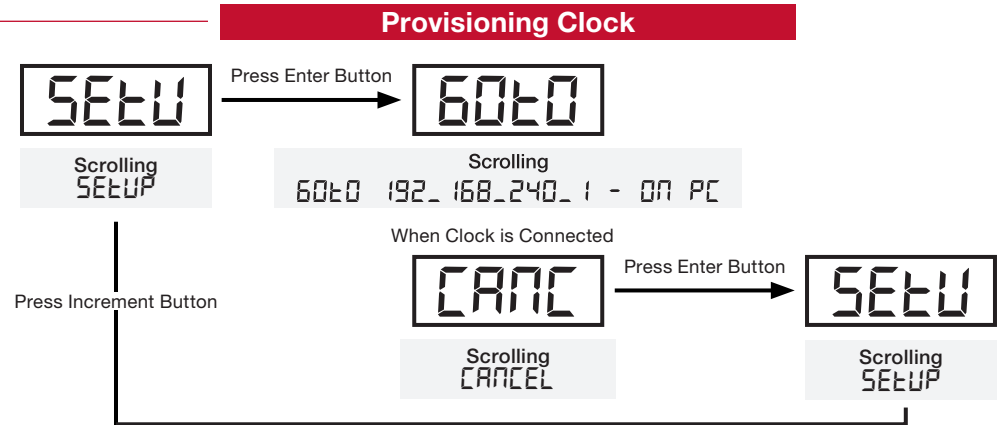

Fig. 2

Sets the clock display to a 12 hour or 24 hour time format.

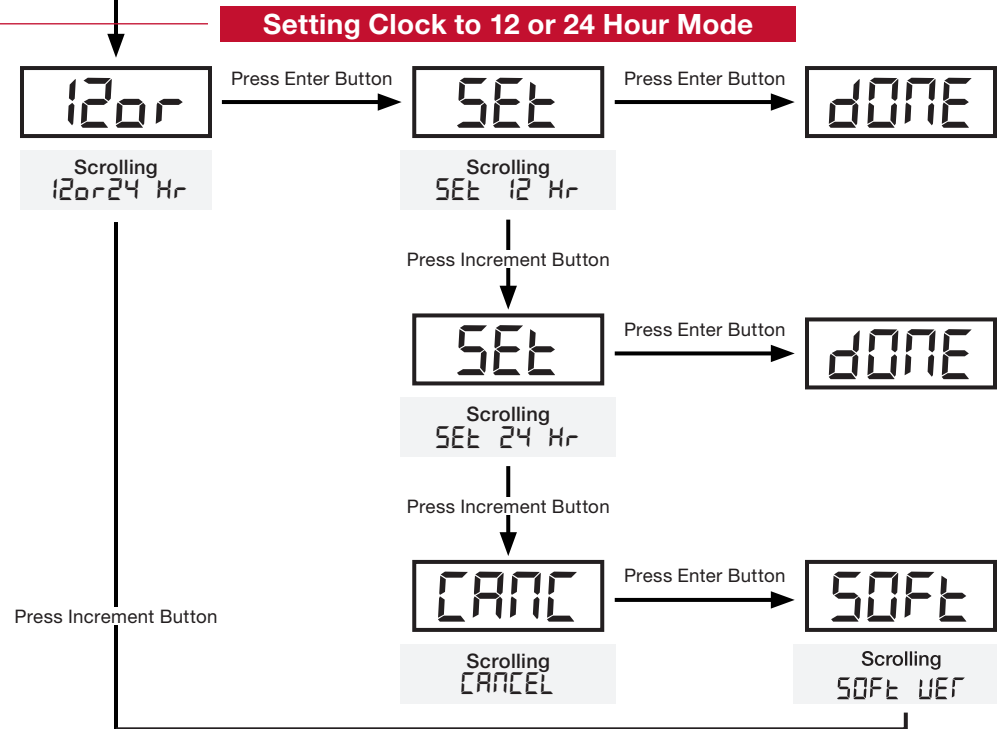

Fig. 3

Display the software version currently installed.

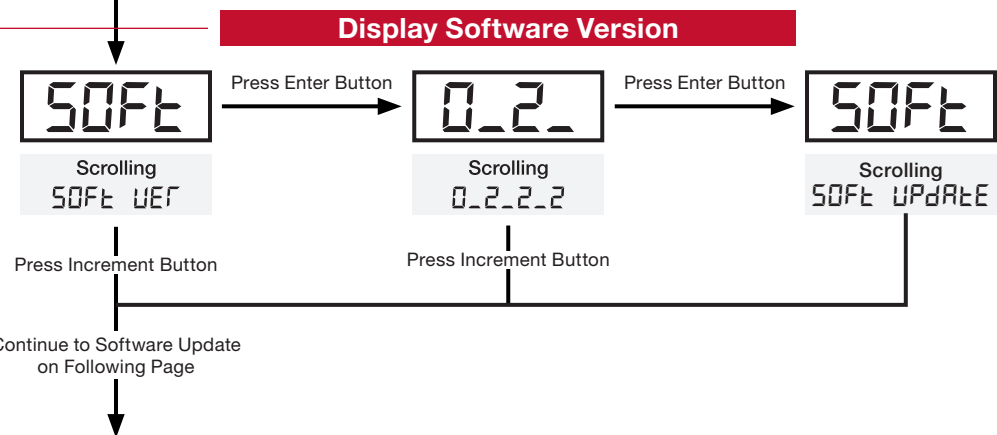

Fig. 4

Update the firmware via access to the internet through port 80.

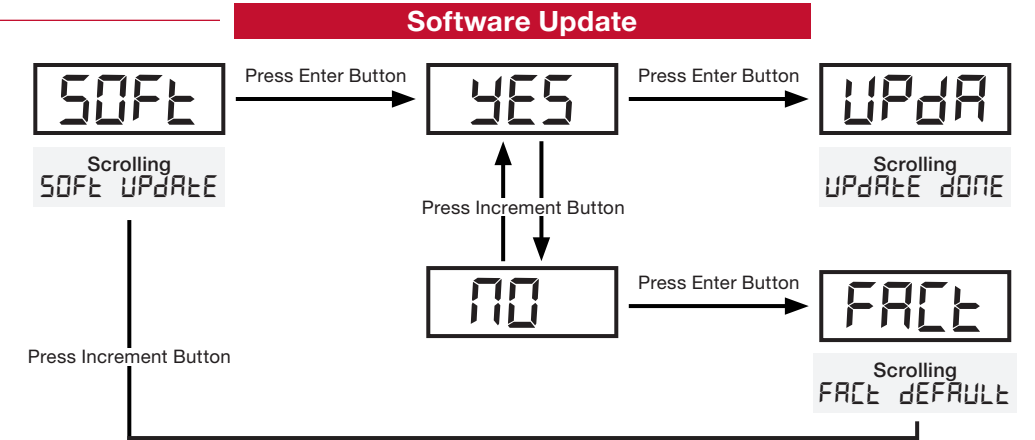

Fig. 5

Restore the clock to the preconfigured factory settings.

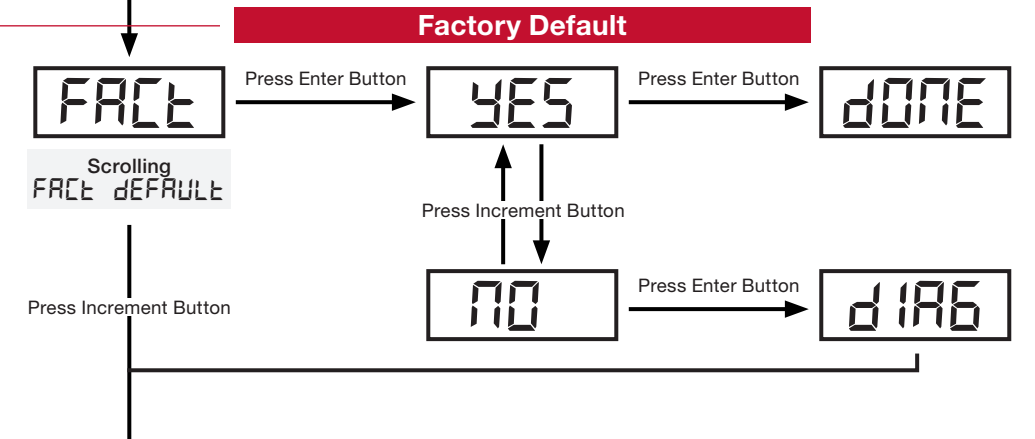

Fig. 6

Run connection diagnostics on the clock.

